

2.2.1 Timor-Leste Presidente Nicolau Lobato International Airport

- [Runways](#)
- [Helicopter Pad\(s\)](#)
- [Airport Infrastructure Details](#)
- [Passenger and Cargo Performance Indicator](#)
- [Airport Operating Details](#)
- [Storage Facilities](#)
- [Airfield Cost](#)
 - [Navigation Charges](#)
 - [Fuel Services Charges](#)
 - [Cargo Terminal Charges](#)
 - [Air-bridge Charges](#)
- [Security](#)
- [Companies Available](#)

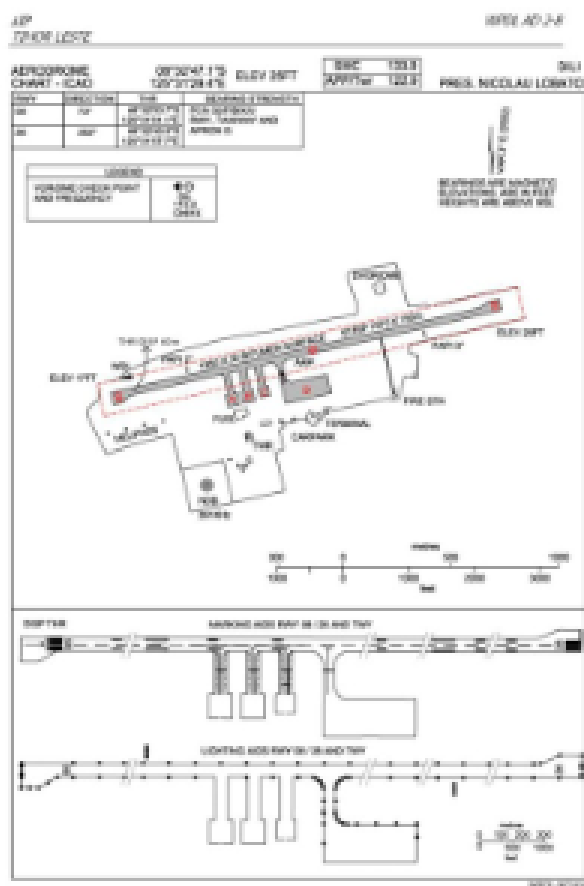

Location Details			
Country	Timor-Leste	Latitude	-8.546417
Province / District	Dili	Longitude	125.5248
Town or City (Closest)	Dili	Elevation (ft)	25 ft
Airfield Name	Presidente Nicolau Lobato International Airport	IATA and ICAO Codes	IATA: DIL, ICAO: WPDL
Open From (hours)	6:00	Open To (hours)	18:00

Runways

Aprons and taxiways:

Apron D (Main apron) 215 x 87 m. Surface: Asphalt. Capacity limited.

Aprons A, B & C generally for UN aircraft.

A single central taxiway is 110m x 23m with an asphalt surface and connects runway to Apron D; aprons A, B & C connected to runway via connecting taxiways

Due to the runway length the maximum size of aircraft capable of landing is B737 equivalent. B767's have landed in the past.

Runway #1	
Runway Dimensions	1,850 m x 30 m (usable length - 1630)
Orientation	073° / 253°
Surface	Asphalt

Helicopter Pad(s)

Helicopters must use runway for take off and landing ground taxi to and from the aprons.

Helipad #1	
Present (Yes / No)	Yes
Largest helicopter that can land	MI – 26 (26MT)
Width and Length (metres)	(Ref. runway and apron dimensions above).
Surface	Asphalt

Airport Infrastructure Details

Administrative operational hours are stated as 09:45 – 21:30 for administrative, customs and immigration services, sanitation services are available and health services are not.

Presidente Nicolau Lobato International Airport is category IV for firefighting services with 13 trained personnel deployed as 4 personnel per shift. Rescue equipment includes 2 x Ultra Large Foam Tenders, 1 ambulance with basic aircraft cutting equipment.

Customs	Yes	JET A-1 fuel	Yes
Immigration	Yes	AVGAS 100	n/a
Terminal Building	Yes	Single Point Refueling	n/a
Passenger Terminal	Yes	Air Starter Units	Yes
Cargo terminal	Yes	Ground Power (mobile)	Yes
Pax transport to airfield	n/a	Ground Handling Services	Yes
Control Tower	Yes	Latrine Servicing	Yes
Weather Facilities	Yes	Fire Fighting Category (ICAO)	Yes
Catering Services	n/a	De-icing Equipment	n/a
Base Operating Room	Yes	Parking Ramp Lighting	Yes
Airport Radar	Yes	Approach & Runway Lights	Yes
NDB	Yes	VOR	Yes
ILS	Yes		

Passenger and Cargo Performance Indicator

Performance for 2009	Annual Figures	Monthly	Daily
----------------------	----------------	---------	-------

Total aircraft movements	Once daily flights to Darwin and Bali Once daily charter flights for Oil Companies Once daily charter flights for PDL TOLL for ISF Daily UN MI8 flights to and from districts Daily Black Hawk recon flights ISF Twice daily Super Puma flights to oil rigs in Coral Sea	n/a	n/a
Total passengers	Information Not Available from CAD	n/a	n/a
Total capacity of the airport (metric tonnes)	Information Not Available from CAD	n/a	n/a
Current activity of the airport (metric tonnes)	Information Not Available from CAD	n/a	n/a
Current use by Humanitarian flights (UNHAS)	None	n/a	n/a

Airport Operating Details

Operating Details			
Maximum sized aircraft which can be offloaded on bulk cargo:	B737*		
Maximum sized aircraft that can be offloaded on pallet	B737*		
Total aircraft parking area (m²)	18,700m ²		
Storage Area (mt)	See below section on storage	Cubic Meters (m³)	n/a
Cargo Handling Equipment Available (Yes / No)	No	If "Yes" specify below	
Elevators / Hi Loaders (Yes / No)	No	Max Capacity (mt)	n/a
Can elevators / hi loaders reach the upper level of a B747 (Yes / No)	n/a		
Loading Ramps (Yes / No)	n/a		

*Due to the runway length the maximum size of aircraft capable of landing is B737 equivalent. B767's have landed in the past.

Storage Facilities

The airport host no public storage facilities, these are arranged by the ground handling crews who have limited storage capacities in the airport (STAT have 4 containers and an open compound approximately 500m²), the ground handling companies can assist in arranging storage space in Dili town.

The airport directorate does not provide any storage at present; this is left entirely to the two ground handling companies (SDV and STAT) that are currently operating in the airport, both have limited storage facilities in the airport and offer freight forwarding services.

Airfield Cost

Navigation Charges

Note: Helicopters are charged at a fixed rate of 20.00 USD per landing.

Aircraft weight – MTOW (kg)	Charges (US\$)
< 5,000	Quoted on a case by case basis.
5,001 10,000	Quoted on a case by case basis.
10,001 20,000	Quoted on a case by case basis.
20,001 30,000	Quoted on a case by case basis.
30,001 40,000	Quoted on a case by case basis.
40,001 50,000	Quoted on a case by case basis.

BAE 146 - A319	450 USD
B727 – MD80	500 USD
B757 – A320	500 USD
Hercules C130 IL76	550 USD
B707 DC8 IL62	550 USD
B767 A310 IL86	550 USD
A330 MD11 DC10	N/A
B747 B777 AN124	N/A

Aircraft Weight - MTOW (kg)	Landing	Night landing
0 – 5,000	40.00	20.00
5,001 – 10,000	200.00 + 5.00 / MT	100.00 + 2.50 / MT
10,001 – 15,000	250.00 + 5.00 / MT	125.00 + 2.50 / MT
15,001 – 30,000	275.00 + 5.00 / MT	137.50 + 2.50 / MT
30,001 –50,000	300.00 + 5.00 / MT	150.00 + 2.50 / MT
50,000 and over	325.00 + 5.00 / MT	162.50 + 2.50 / MT

Service	Ad-Hoc / USD
Pallet Handling Charge Per aircraft	Quoted on a case by case basis.
Cargo Per kg	15USD<40KG, 0.40USD<750Kg, 0.35USD<1700 Kg, 0.30USD <3000 Kg
Chocks Per operation	15USD
Stairs Per operation	Manual 75 USD, Motorized 120 USD
GPU Per operation	128 USD
ASU Per hour	N/A
Loader Per hour	Quoted on a case by case basis.
Toilet Service Per aircraft	95 USD Cleaning, 85 USD Water
Pushback Per operation	N/A
Trailer Per operation	N/A
Traffic Handling Per operation	N/A
Check-in Per aircraft	Quoted on a case by case basis.
Documents Per aircraft	Quoted on a case by case basis.

Fuel Services Charges

Pertamina and Air BP are the only commercial fuel supplier that serve aircraft at Presidente Nicolau Lobato International Airport. They do not make any additional surcharges for re-fuelling the aircraft and only charge the cost of the fuel (prices are updated on a monthly basis).

PDLTOLL also operate in the airport to refuel UN and ISF aircraft, they cannot serve additional operators as they are importing fuel into Timor-Leste on a tax exempt basis.

Reference herein to services or the use of any firm or corporation name is for the information only and in no manner constitutes an endorsement or recommendation by the WFP.

For information on Timore-Leste Airport Fuel providers contact details, please see the following link:

[4.5 Timor-Leste Airport Company Contact List](#)

Cargo Terminal Charges

Ground Handling Company

There are two private ground handling companies (SDV and STAT) that are currently providing all the cargo handling , aircraft handling and aircraft servicing operations in the airport, none of these services are undertaken by the airport authorities directly.

PDLTOLL and UNMIT Movcon provide these services for the UN and ISF operations.

SDV exclusively have an arrangement for transit passengers, this is exclusively for international oil company staff that arrives in Dili on route to locations / oil rigs in the Coral Sea.

Aircraft Handling	Cargo handling	Passenger Handling
SDV / STAT / PDLTOLL / UNMIT	SDV / STAT / PDLTOLL / UNMIT	SDV /STAT (commercial)

Import	Rate US\$ / kg
Handling Charge per kg	0.10 USD/KG
Break Bulk Fee	0.10 USD/KG
Diplomatic Mail	5USD inclusive admin charge.
Strong Room – per consignment	0.10 USD/KG
Cold Storage Fee	n/a
Delivery outside normal working hours	10.00USD<40KG, 30.00USD<750Kg, 40.00USD<1700 Kg, 50.00USD <3000 Kg
Preparation of substitute AOA – Invoice – Receipt	5USD inclusive admin charge.
Storage per kg per day – Grace period? hours	48 hours free, then 0.03USD/Kg/Day
Export	Rate US\$ / kg
Handling charges – Unpalletized cargo	0.10 USD/KG
International Air WayBill	5USD inclusive admin charge.
Local Air WayBill	5USD inclusive admin charge.
Air Way Bill Amendment - Cancellation	5USD inclusive admin charge.
Air Way Bill Documentation	5USD inclusive admin charge.
Diplomatic Mail	5USD inclusive admin charge.
Storage charges per kg per day	48 hours free, then 0.03USD/Kg/Day

Note: Rates are indicative. No formal pricing system is in place. Cargo terminal charges should be verified with the respective Ground Handling Company on a case-by-case basis.

Air-bridge Charges

An agreement between UNMIT, CAD and Australian armed forces has been made with the government of Timor-Leste to facilitate the evacuation of UN and ISF personnel in the event of civil unrest / conflict. However any special fees levied for such operations have not been formally established, CAD director indicated that usual landing fees would apply.

Security

Level: Bad

There is a fence surrounding the airport and several security providers maintaining a presence in the airport, this includes: a UNPOL patrol, approximately 20 BPU (Timorese Border Patrol Unit) personnel, and approximately 20 airport security officers. The access fence at the start of runway 26 (East-Northeast of the airport grounds) is closed with a locked gate, and not guarded. However, during unrest this access point is a good alternative if the public area of the main terminal building is volatile. The Airport directorate has procured a container x-ray scanner which should be established and operational in early 2010.

Companies Available

For information on Timore-Leste Airport contact details, please see the following link:

[4.5 Timor-Leste Airport Company Contact List](#)

Information on some aviation service providers can be found at: [AZ Freight information on Timor-Leste](#)